

### 1. Introduction

Read this manual carefully prior to working with the BigBagCar® S96/S99 to avoid accidents.

The aim of this manual is to ensure the safe and correct use of the BigBagCar® S96/S99. The cart may only be used for its intended purpose, i.e. the transportation and unloading of FIBC (Flexible Intermediary Bulk Container) bags up to a maximum weight of 1000 kg. The user should first read the operating manual to ensure a safe use of the BigBagCar® S96/S99. The manual gives guidelines for this transportation. In order to realize a longer life of the BigBagCar® the maintenance specifications need to be observed.

### 2. General description

The BigBagCar® S96/S99 is a transportation device with which FIBC bags (60x90x115cm/90x90x115cm) can be transported. The FIBC bag can be taken off the cart without electronics or without the use of a complex system. The operator of the BigBagCar® S96/S99 tilts the bottom of the cart so that the FIBC bag partially touches the ground and remains balanced. All the operator has to do is pull the BigBagCar® S96/S99 away and the bag stays upright on the ground.

As the BigBagCar® S96/S99 can be dismantled it is easy to transport it from one workplace to another. Once dismantled the BigBagCar® S96/S99 consists of 5 separate parts each weighing less than 25kg (ARBO; working conditions act). The BigBagCar® has been designed in such a way that it can be dismantled and transported by one person.

### 3. Intended use

- The BigBagCar® S96/S99 is intended solely for the placement, filling, transportation and then unloading of FIBC bags (60x90x115 cm/90x90x115 cm) with a maximum laden weight of 1000 kg.
- The tilting of the base is solely meant for placing the refuse bag on the ground.
- The BigBagCar® S96/S99 should only be used on a hardened, flat surface.

### 4. FIBC bag

The FIBC bags that are used on the BigBagCar® S96/S99 should have the following dimensions: standard normalized 60x90x115/90x90x115 (l x b x h in cm). The safety factor should be 5:1. The maximum load capacity is 1000 kg. Bags from different suppliers can vary in the length of the loops.

### 5. Misuse of the BigBagCar® S96/S99

- It is not permitted to use the BigBagCar® S96/S99 to transport people.
- It is not permitted to hoist the BigBagCar® S96/S99. The eyes on the top of the side frame are only intended to ensure that the loops of the FIBC bag do not slide off the frame (see Figure 3).
- It is not permitted to pull the BigBagCar® S96/S99 by means of a motorised vehicle.

### 6. Assembly instructions

The below exploded-view drawings can help in the assembly for use of the BigBagCar® S96/S99.

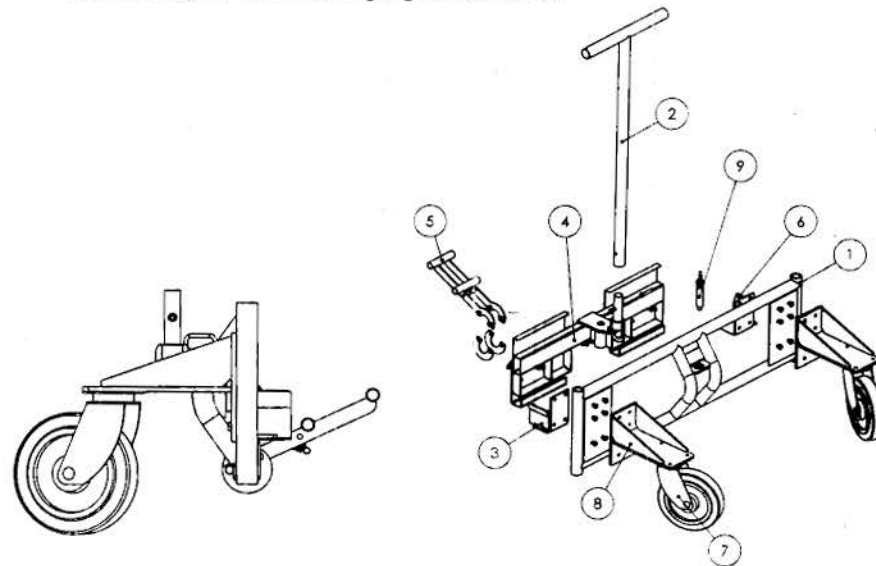

**Figure 8:** Exploded view of back frame

**NB!** Attach parts 3 and 6 as much as possible on the outside.

#### List of parts figure 6

1. Frame
2. Rotation axis
3. Wheel 200-50-140

#### List of parts figure 8

1. Frame rear 90
2. Pull bar
3. Support platform, left
4. Uncouple mechanism
5. Support hook

#### List of parts figure 7

1. Locking pin (big)
2. Locking pin (small)
3. Locking pin (small)
6. Support platform, right
7. Swivel caster 200x50-14
8. Wheel support
9. Locking Pin (small)

## 7. Operation procedures

The correct procedure for working with the BigBagCar<sup>®</sup> S96/S99 is described below. The figures in this chapter serve to illustrate the explanation.

### 7.1. Assembly for use

- When assembling the BigBagCar<sup>®</sup> S96/S99 one should stand on the inside of the BigBagCar<sup>®</sup>.
- Attach the first side frame using a long pin (no. 1 in Figure 7) at the bottom of the back frame.
- Attach the second side frame using a long pin (no. 1 in Figure 7) at the bottom of the back frame.
- Place the top rod of the back frame using the two short pins (no. 2 in Figure 7) between the side frames. Ensure that the two hooks hang on the outside of the frame.
- Tilt the base plate by standing on the front rim, then pull the BigBagCar<sup>®</sup> underneath the base plate, and afterwards lower the base plate (see Figure 10 to 12 on page 17).
- Lock the base plate using a short pin (no. 3 in Figure 7).

#### Note!

- Incorrect assembly of the BigBagCar<sup>®</sup> S96/S99 may lead to a risk of physical injury.

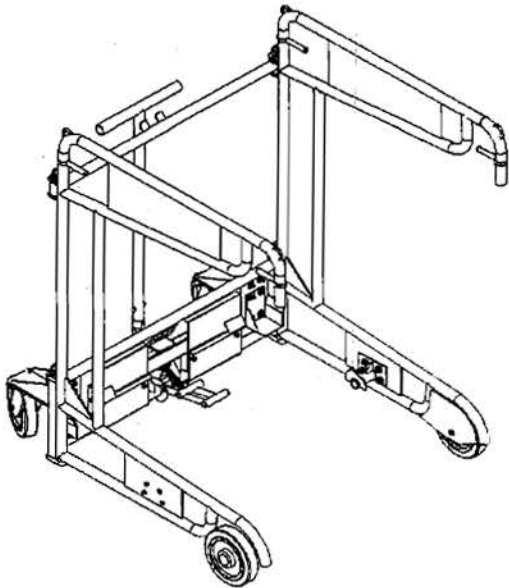

**Figure 9:** BigBagCar<sup>®</sup> S96/S99 without base plate  
 Above figure shows the BigBagCar<sup>®</sup> S96/S99 without base plate.  
 The car should first be assembled in this manner before the base plate is attached.

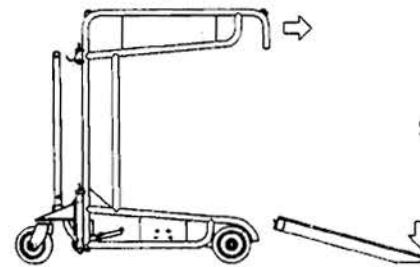

Figure 10

#### Step 1:

Stand on the front side of the base plate so that it tilts as shown in Figure 10. Then pull the BigBagCar<sup>®</sup> S96/S99 towards you.

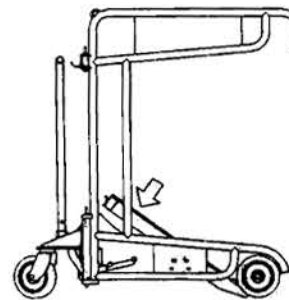

Figure 11

#### Step 2:

Let the base plate tilt back into place as shown in Figure 11.

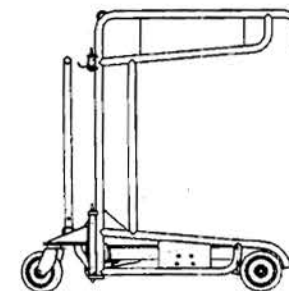

Figure 12

#### Step 3:

Lock the base plate. The BigBagCar<sup>®</sup> S96/S99 now looks as shown in Figure 12.



### 7.2. Lacing an FIBC bag

- Put both brakes on the BigBagCar<sup>®</sup> S96/S99.
- Check to see whether the base plate is locked.
- The loops are laid up against the eye, after which they are folded behind the pin in the steel plate and firmly lashed. (figure 1 & 2).

#### Note!

- Ensure that the FIBC will not get stuck between the moving parts of the BigBagCar<sup>®</sup> S96/S99, as this may cause problems when unloading the FIBC bag.

### 7.3. Filling an FIBC bag

- Spread out the load evenly over the surface of the base plate.
- Ensure that the unlocking pin of the base plate remains accessible when the FIBC bag is full.

#### Note!

- Do not fill the FIBC bag with more weight than the permitted 1000 kg.
- If a full FIBC bag does not allow for the locking pin to be removed, it is impossible to unload the FIBC bag.
- If the bag is filled up higher than the BigBagCar<sup>®</sup> S96/S99 it is possible that the FIBC bag will topple over while being unloaded.
- Never throw heavy objects from a great height into the bag. This may cause damage to the base plate.

### 7.4. Tilting the base plate

- Put the BigBagCar<sup>®</sup> S96/S99 on both brakes.
- Take the loops of the FIBC bag off.
- Unlock the base plate by removing the locking pin (no. 3 in Figure 7).
- Let the base plate tilt using the pull bar. This can be done in 2 ways:
  1. Remove the pull bar from the hanging hooks and then push straight down.
  2. Remove the pull bar from the hanging hooks and then pull the bar parallel to the subfloor.
- Undo the brakes of the BigBagCar<sup>®</sup> S96/S99.
- Pull the BigBagCar<sup>®</sup> S96/S99 from underneath the FIBC bag. (With a load weighing 1000 kg it is recommended that this is done by two people).
- Put the BigBagCar<sup>®</sup> S96/S99 on both brakes.
- Lock the base plate using the locking pin (no. 3 in Figure 7).

#### Note!

- When the loops of the FIBC bag are undone incorrectly, the BigBagCar<sup>®</sup> S96/S99 may get damaged.
- If the loops are still attached to the BigBagCar<sup>®</sup> S96/S99 while unloading, do not try to undo them by hand.
- Ensure there is enough room to remove the BigBagCar<sup>®</sup> S96/S99 from underneath the FIBC bag.
- If only one brake is used the BigBagCar<sup>®</sup> S96/S99 may be able to move by itself.
- Do not have your feet underneath the base plate when tilting

### 7.5. Dismantling after use

- Put the BigBagCar<sup>®</sup> S96/S99 on both brakes.
- Remove the base plate by lifting this on the front side.
- Remove the upper bar of the back frame by first removing the two short pins (no. 2 in Figure 7).
- Remove one of the two side frames by first removing the long pin (no. 1 in Figure 7). Put one foot underneath the back frame and the other underneath the side frame. Ensure that your leg is placed against the back frame as this will tilt as soon as you remove the side frame.
- Remove the second side frame by first removing the long pin (no. 1 in Figure 7).

#### Note!

- Incorrect dismantling of the BigBagCar<sup>®</sup> S96/S99 may lead to a risk of physical injury.

### 8. Transport

The BigBagCar<sup>®</sup> S96/S99 must always be dismantled when transported. During transport of the BigBagCar<sup>®</sup> S96/S99 in its dismantled form all parts must be firmly secured to the vehicle to that the parts cannot slide.

#### Note!

- If the separate parts of the BigBagCar<sup>®</sup> S96/S99 are not secured well, this may damage the vehicle and/or the BigBagCar<sup>®</sup> S96/S99.

### 9. Maintenance requirements

The BigBagCar<sup>®</sup> S96/S99 does not require much maintenance. This does not mean, however, that maintenance should be completely ignored. The pin/hole connections between the various parts need to be kept clean at all times. This is necessary in order to ensure a correct connection. If the wheels make a noise or feel heavy, the wheel bearings need to be lubricated. If the problem remains, the wheel bearings need to be replaced.

### 10. Technical appendices BigBagCar<sup>®</sup> S96/S99

- FIBC : 60 x 90 x 115cm / 90 x 90 x 115cm

	S96	S99
Mass	±94kg	±106kg
Maximum loading weight	1000kg	1000kg
Material	white steel	white steel
Surface finishing	powder coating	powder coating

